



BY-T1

Durable Mini Tripod

多功能三脚架

Instruction Manual
使用手册



Components:

产品结构

- 1. 1/4" screw
- 2. Ball head
- 3. Locking screw for ball head
- 4. Locking knob for extension pole
- 5. Extension pole
- 6. Feet adjustment knob
- 7. Mini tripod

- 1. 1/4" 螺丝
- 2. 球形云台
- 3. 球头锁紧旋钮
- 4. 延长杆锁紧旋钮
- 5. 可伸缩延长杆
- 6. 脚架高度调节旋钮
- 7. 迷你三脚架

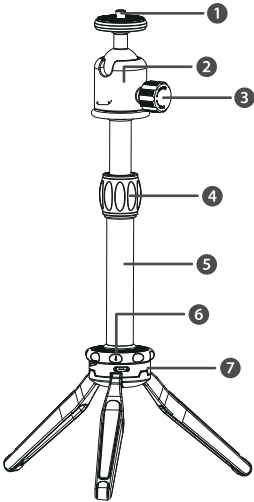

Features:

- Solid aluminum alloy construction
- Angle adjustable feet
- Comes with adjustable extension pole
- Flexible ball head
- Compatible with smartphones, action camera and DSLRs

特点:

- 铝合金结构, 坚固耐用
- 可调节脚架
- 配备可伸缩延长杆
- 360°可旋转球形云台
- 兼容智能手机、运动相机和单反相机

Specifications:

Max load capacity:	5KG
Size:	φ165x280mm (Min)
	φ135x400mm (Max)
Weight:	304g (36.7oz)

参数:

最大承载重量:	5KG
尺寸:	φ165x280mm (最小)
	φ135x400mm (最大)
重量:	304g

Set up:

使用方法

Step 1:

If you need to shoot at different heights, mount the extension pole onto the mini tripod, ensure it is locked tightly.

步骤一:

如果需要在不同高度拍摄, 请将延长杆安装在迷你三脚架上, 并确保其锁紧。

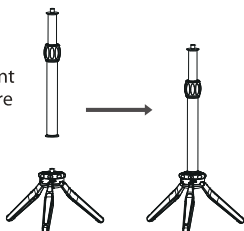

If you do not need to shoot at different heights, then mount the ball head onto the mini tripod directly as shown.

若无拍摄高度要求的情况下, 可将球形云台直接安装到迷你三脚架上, 如图所示。

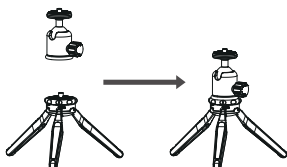

Step 2:

Mount the ball head onto the extension pole, make sure it is locked tightly.

步骤二:

将球形云台安装到延长杆上, 确保其锁紧。

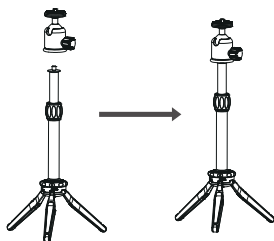

Step 3:

Shooting with smartphone.

Lock the smartphone holder onto the ball head, adjust the ball head to a desired angle, then lock the ball head tightly. (Smartphone holder is sold separately)

步骤三:

用智能手机拍摄。

将手机支架固定在云台上, 将球头调整到所需的角, 然后将球头锁紧。(智能手机支架另行出售)

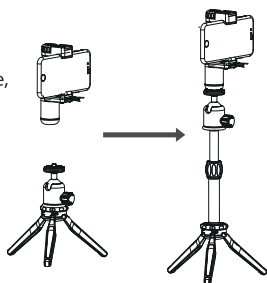

When mounting the DSLRs onto this mini tripod, do not need any adapter, just mount the DSLRs onto the ball head directly.

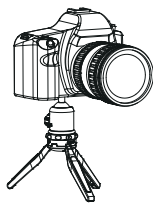

将单反相机安装到迷你三脚架上时，无需任何适配器，只需将单反相机直接安装到球形云台上即可。

When mounting the action cameras onto this tripod, an adapter will be need, the adapter is purchased separately



将运动相机安装到三脚架上时，则需通过适配器安装。（适配器需单独购买）

Step 4:

Adjust the height of the feet:

1. BY-T1 can be folded up in any position, and before adjusting the angle of the feet, the feet must be folded up.



步骤四:

三脚架高度调节:

1. 在调整脚架高度之前，请将三脚架收纳起来，解锁调节旋钮；否则，调节旋钮处于锁定状态。
2. Rotate the adjustment knob on mini tripod clockwise, the feet will be at a smaller angle, and in this situation, the tripod will be in a taller position.
2. 将旋钮朝顺时针旋转，为调高脚架模式。

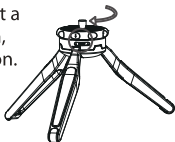

3. Rotate the adjustment knob on mini tripod counter-clockwise, the feet will be at a wider angle, and in this situation, the tripod will be in a lower position.

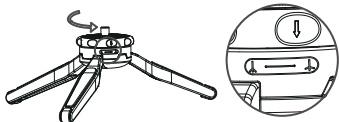

3. 将旋钮朝逆时针旋转，为降低脚架模式。

Step 5:

Adjust the ball head:

Turn the ball head locking screw counter-clockwise, then adjust the upper part to a desired position, turn the ball head locking screw clockwise to tight it up.

步骤五:

云台角度调节:

逆时针旋转扭松旋钮，根据自身拍摄需要调整至合适角度，再顺时针拧紧。

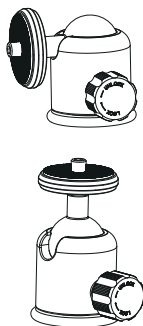

Step 6:

Adjust the extension pole:

Turn the extension pole locking knob counter-clockwise and adjust the extension pole to a desired height, then turn the locking knob clockwise and make sure it is securely fastened.

步骤五:

延长杆长度调节:

逆时针旋转扭松旋钮，根据自身拍摄需要调整至合适长度，再顺时针拧紧。

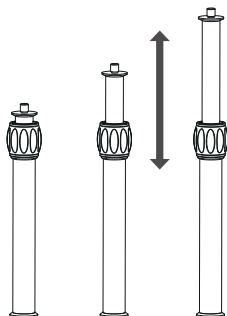

www.boya-mic.com

SHENZHEN JIAZY PHOTO INDUSTRIAL., LTD.

The BOYA logo is a trademark which is registered and owned by Shenzhen Jiayz Photo Industrial., Ltd.

深圳市长丰影像器材有限公司

地址:深圳市龙华区观澜街道大富社区硅谷动力智能终端产业园A16栋

TEL: 400 6131096

Email: sales@boya-mic.com

www.boya-mic.com / www.jiayz.com