

BOYA

Wireless Vibrant Lighting USB Microphone

无线桌面麦克风

BOYA K5

User Manual
用户手册

Statement

Please read this manual carefully before using, and strictly operate and store it in accordance with the instructions. Please save the manual for future reference. If you need further assistance than the user manual, please consult your retailer for help or email us at: support@boya-mic.com

Cautions

1. Do not use the microphone underwater or expose it to rain. Please store it in a cool, dry place.
2. Use and store the microphone at a normal temperature. Do not frequently move it between hot and cold environments. Please keep it away from heat sources such as heaters, ovens.
3. When using and storing, please keep away from dust and moisture.
4. Avoid harsh impacts and collisions on the microphone.
5. Do not position the microphone close to the speakers to prevent audio feedback.
6. For the best pick-up pattern, do not hold your hand against the microphone.

General Introduction

The K5 Wireless Desktop Microphone is a USB condenser microphone that supports both wired and wireless dual-mode connections, offering flexibility for various usage scenarios. It features multiple built-in RGB lighting effects that enhance the atmosphere of your gaming or live streaming environment. Equipped with an integrated shock mount and a stable desktop stand, it effectively reduces vibrations and accidental noise during daily use. The built-in windscreen and pop filter help minimize plosive sounds and airflow noise, ensuring clear and clean audio capture. The LED indicator displays the microphone's real-time status at a glance, while the tap-to-mute function allows you to quickly mute the mic and avoid unexpected interruptions during streams. With AI-powered noise cancellation, gain control, headphone volume adjustment, and balance settings between computer and microphone audio, the K5 makes it easy to fine-tune your sound and deliver high-quality audio output.

Product Structure

Transmitter(BOYA K5-TX)

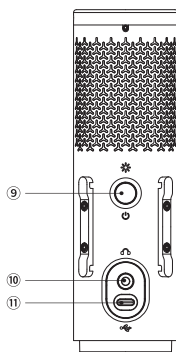
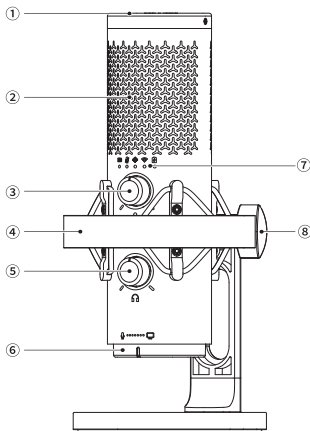

Receiver(BOYA K5-RX)



① Mute / NR Button

Mute: Lightly tap the top once to mute or unmute the microphone.

Noise Cancellation: Press and hold the top for 2 seconds to enable or disable noise cancellation.

② RGB Light

③ Microphone Gain Control Knob

Rotate the knob to adjust the microphone gain.

④ Shock Mount (With Pop Filter)





⑤ Headphone Volume knob

Rotate the knob to adjust the headphone monitoring volume as needed.

⑥ Gain / Volume Adjustment Knob

Rotate the knob to adjust the microphone gain and computer monitoring volume balance.

⑦ Function Indicator

Function	Status	Indicator
ENC Noise Cancellation	Noise cancellation enabled	Solid white
	Noise cancellation disabled	White light off
 Mute	Mute	Solid red
	Unmute	Red light off
 Audio Level	Capturing audio	Blinks white
	Not capturing audio	White light off
 Wireless Signal	Unpaired	Blinks white slowly
	Pairing	Blinks white quickly
	Paired successfully	Solid white
 Battery Capacity	Low battery	Blinks white quickly
	Charging	Blinks white slowly
	Fully charged	Solid White

NOTE: The operating status of each microphone function icon corresponds to the status of the indicator below.

⑧ Adjustment Knob

Loosen this knob to adjust the microphone's angle for a better sound pick-up.

⑨ Power / Pairing / RGB Lighting Effect Button

- Press and hold for 3 seconds to power on or off.
- Press this button three times to re-pair the transmitter with the receiver. (The transmitter and receiver are pre-paired before leaving the factory. Therefore, they will automatically pair once powered on. Their indicators will turn solid white when the pairing is successful.)
- Press this button once to cycle through RGB effects.

Cycle through the lighting effects	Ripple effect
	Breathing effect
	Red
	Magenta
	Orange
	Light green
	Green
	Light blue
	Deep blue
	Purple
	White
	Light off

NOTE: When the microphone is muted, pressing this button once will not change the lighting effects.

⑩ **3.5 mm Headphone Jack**

Connect headphones for real-time monitoring.

⑪ **USB-C Charging / Audio Output Port**

After connecting the included USB-C to USB-C or USB-C to USB-A data cable, the transmitter can be charged and can output audio to devices such as smartphones with a USB-C port or computers with USB-C or USB-A ports.

NOTE:

After the transmitter and receiver are successfully paired, do not charge the transmitter via the USB-C to USB-C or USB-C to USB-A data cable to avoid abnormal current noise.

⑫ **Status Indicator of Receiver**

Insert the receiver into a device with a USB-C or USB-A port. The receiver's status indicator will display as follows:

- Unpaired with the transmitter: blinks white slowly.
- Pairing: blinks white quickly.
- Pair with the transmitter successfully: solid white.

Pop Filter Installation

Align the bottom of the pop filter with the two slots on the shock mount and insert it into place as shown in the figure below.

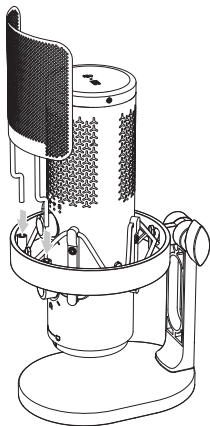

Boom Arm Installation

(1) Rotate the adjustment knob counterclockwise to remove the microphone from the desktop stand.

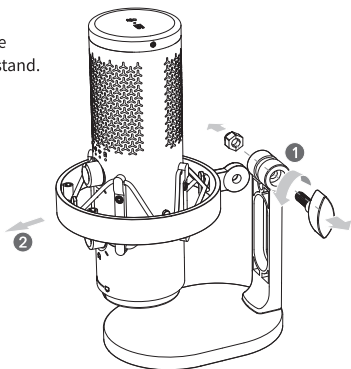

(2) Using the included 5/8" to 3/8" threaded adapter to screw the microphone into the boom arm as shown in the figure below.

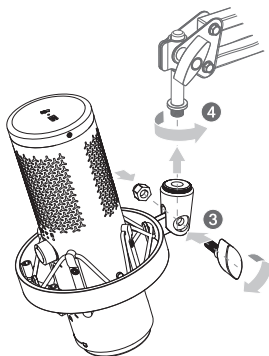

Operation Guide

Microphone Activation

Wired Connection:

Connect the microphone to your phone, computer, or other device using the included data cable. When connecting to a computer, you may need to configure program settings. For details, refer to the “Program Settings (Wired Connection)” section.

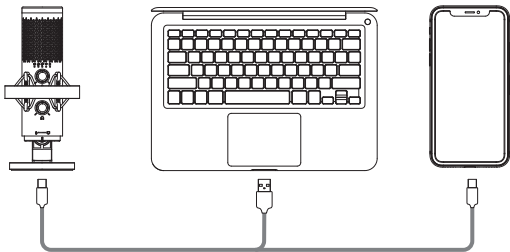

Wireless Connection:

Connect the microphone to your phone, computer, or other device using the included receiver.

When connecting to a computer, you may need to configure program settings. For details, refer to the “Program Settings (Wireless Connection)” section.

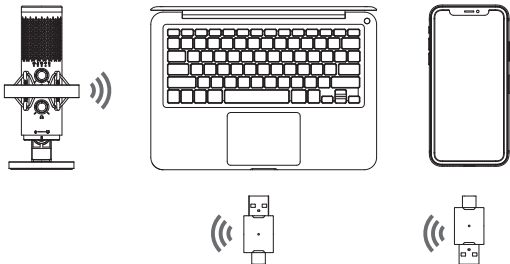

Microphone Placement

With a cardioid pattern, the microphone capsule of the K5 is located on the front of the microphone. This pattern provides the best sound pickup from directly in front of the microphone. For optimal audio capture, it is recommended to position the microphone facing the sound source and maintain a distance of 5 to 15 cm.

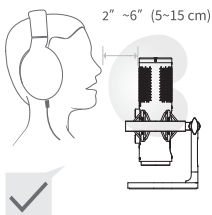

Facing the microphone capsule

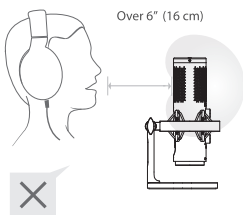

Opposite to the microphone capsule

Mute

Lightly tap the top of the microphone once to mute or unmute the microphone. When muted, the RGB light will blink red quickly.



Tap Once

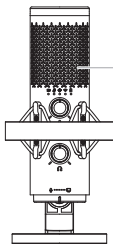

Blinks Red Quickly



Cycle through the lighting effects

Press the Power / Pairing / RGB Lighting Effect Button once to cycle through the lighting effects.

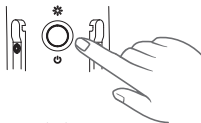

Press this button once

Gain and Headphone Volume Adjustment

Gain: Rotate to the right to increase gain; rotate to the left to decrease gain.



Decrease Gain



Increase Gain

Headphone Volume: Rotate to the right to increase headphone volume; rotate to the left to decrease headphone volume.

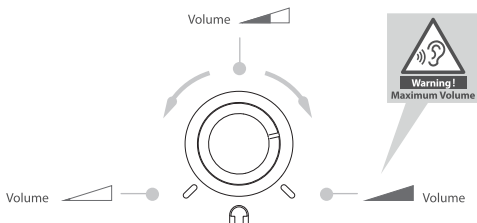

Gain / Volume Adjustment

Rotate to the right to increase computer monitoring volume and decrease microphone gain. Rotate to the left to increase microphone gain and decrease computer monitoring volume.

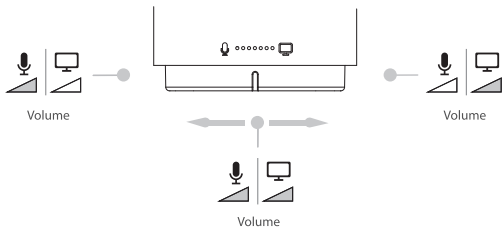

Noise Cancellation

Press and hold the top of the microphone for 2 seconds to enable or disable noise cancellation. It is recommended to enable noise cancellation while recording in a noisy environment. When noise cancellation is enabled, the function indicator will turn solid white; when disabled, the white light will turn off.

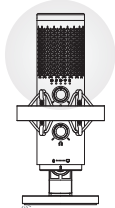

Press and hold for 2 seconds to enable or disable noise cancellation



Re-pair

Insert the receiver into a device with a USB-C or USB-A port, then press this button 3 times to re-pair with the transmitter, and the receiver's status indicator will blink white quickly. When the receiver pairs with the transmitter successfully, the status indicator will glow solid white.

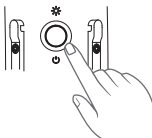

Press this button 3 times



Power on or off

Press and hold for 3 seconds to power on or off.
NOTE:

- This function works only in wireless mode; in wired mode, the transmitter will power on automatically.
- In wireless mode, if the receiver is not successfully paired with the transmitter, the transmitter will automatically power off after 5 minutes.

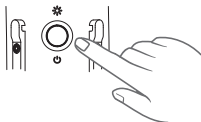

Press and hold this button once

Program Settings (Wired Connection)

Mac System Program Setup

1. Connect the **K5** to your computer using the included data cable.
2. Open **System Preferences**, then select the **Sound** icon.
3. Select **K5 TX** as the input device under the **Input** tab.
4. Select **K5 TX** as the output device under the **Output** tab.

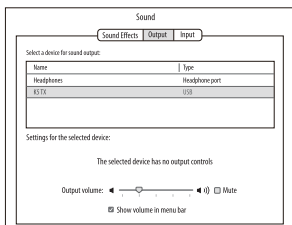
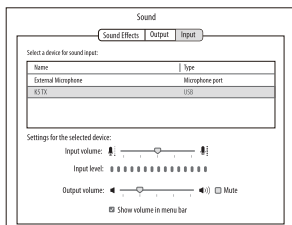

Windows System Setup

1. Connect the **K5** to your computer using the included data cable.
2. Go to **Settings > System > Sound**.
3. In the **Playback** tab, select **K5 TX** as the default device.
4. In the **Recording** tab, select **K5 TX** as the default device.

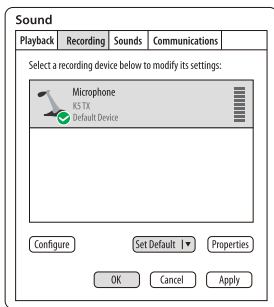
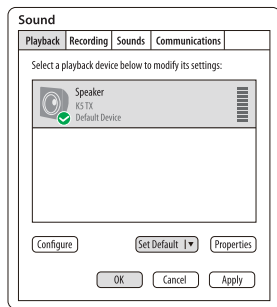

Program Settings (Wireless Connection)

Mac System Program Setup

1. Connect the included receiver to your computer.
2. Open **System Preferences**, then select the **Sound** icon.
3. Select **K5 RX** as the input device under the **Input** tab.
4. Select **K5 RX** as the output device under the **Output** tab.

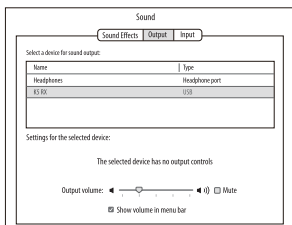
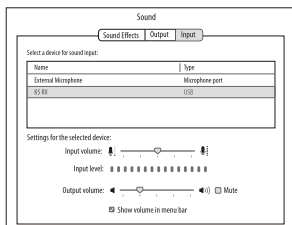

Windows System Setup

1. Connect the included receiver to your computer.
2. Go to **Settings > System > Sound**.
3. In the **Playback** tab, select **K5 RX** as the default device.
4. In the **Recording** tab, select **K5 RX** as the default device.

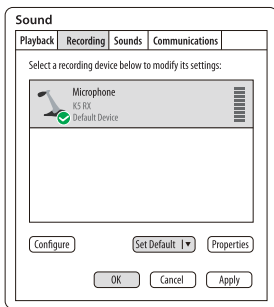
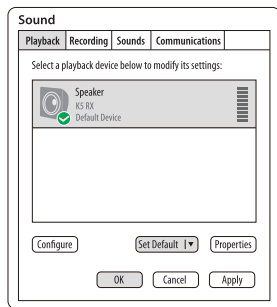

Specifications

Acoustic Principle	Condenser Microphone
Polar Pattern	Cardioid
Frequency Response	20 Hz to 20 kHz
Sensitivity (Maximum Gain)	-10 dBfs at 80 dB spl
Sensitivity (Minimum Gain)	-46 dBfs at 80 dB spl
Sampling Rate	48 kHz
Bit Rate	24 bit
Signal-to-noise Ratio	75 dB
Maximum Sound Pressure Level(SPL)	108 dB SPL
Minimum output Impedance	16 Ω
Port	3.5 mm headphone jack for monitoring
	USB-C output (USB-C 2.0 Hi-Speed)
Battery Capacity	3.7 V 800 mAh
Battery Life	RGB light on: 20 hours;
	RGB light off: 50 hours
Charging Time	3 hours
Transmission Range	10 m
Dimensions (With Shock Mount)	124 x 100 x 221 mm (L x W x H)
Weight (With Shock Mount)	474 g
Power Supply	5 V, 1 A (Max)
Operating System Requirements	Windows: 10.0 or later, macOS: 10.15 or later;
	Android: 9.0 or later, iPadOS*: 14 or later (Apple devices with a USB-C port are required)
Operating Temperature	0°C to +40°C (32°F to 104°F)
Storage Temperature	-20°C to +70°C (-4°F to 158°F); 10 to 95%, not condensing

Polar Pattern

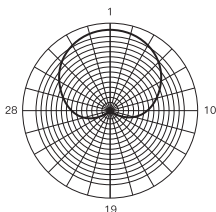

Frequency Response

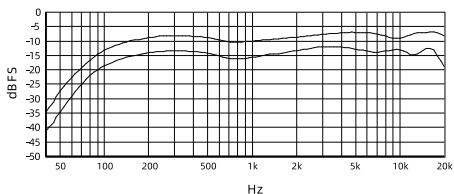

0° and 90° frequency response@80 dB maximum sound pressure level

In the Box

K5 Microphone (With Shock Mount and Desktop Stand) x 1

Pop Filter x 1

USB-C to USB-C / USB-A Data Cable x 1

5/8" to 3/8" Threaded Adapter x 1

Receiver x 1

Mount Adapter x 1

声明

感谢您选择BOYA!

请在使用前仔细阅读本手册,并严格按照说明进行操作和存储。请妥善保存好说明书以供将来参考。如果用户手册不能帮助您解决某些问题,请向零售商寻求帮助或给我们发送电子邮件:support@boya-mic.com

注意事项

1. 不要在水下使用本机,不要将其暴露在雨中。请存放在阴凉干燥处。
2. 请在常温下使用并保存。不要频繁地将其从过热状态移至过冷状态,并远离热源,如加热器、烤箱或其他产生热量的设备。
3. 在使用和储存时,请注意防尘和防潮。
4. 小心避免猛烈的碰撞。
5. 为避免啸叫,请勿将麦克风靠近扬声器。
6. 为获得最佳拾音模式,请勿将手放在麦克风上。

概述

K5 无线桌面麦克风是一款 USB 电容式麦克风,支持有线和无线双模式连接,灵活适配多种使用场景。机身搭载多种 RGB 炫彩灯效,为游戏和直播营造环境氛围感。配备防震架和稳固的桌面支架,有效减少日常使用中的碰撞和振动噪音。内置防风海绵和防喷网,有助于降低齿音和气流声,保障清晰纯净的声音采集。LED 指示灯实时显示麦克风工作状态,轻触即可快速静音,避免直播中的突发状况。AI 智能降噪、增益调节、耳机音量控制以及电脑与麦克风音量平衡等功能,助力灵活调音,轻松实现高质量音频输出。

产品结构

发射器 (BOYA K5-TX)

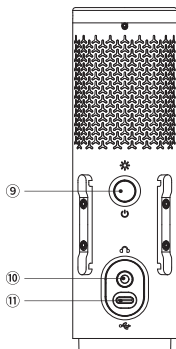
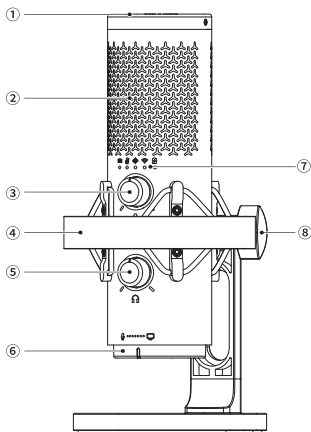

接收器 (BOYA K5-RX)



① 静音键 / 降噪键

- 静音: 轻触一下顶部开启或关闭静音。
- 降噪: 长按顶部2秒可开启或关闭降噪。

② RGB氛围灯

③ 麦克风增益旋钮

旋转可调节麦克风增益。

④ 防震支架 (带防喷网)





⑤ 耳机音量旋钮

旋转可调节耳机音量。

⑥ 增益 / 音量调节旋钮

旋转可调节麦克风增益和电脑监听音量比例。

⑦ 功能指示灯

功能	状态	指示灯
ENC 降噪	降噪开启	白灯常亮
	降噪关闭	白灯熄灭
 静音	静音开启	红灯常亮
	静音关闭	红灯熄灭
 电平	正在拾音	白灯闪烁
	未拾音	白灯熄灭
 无线信号	未连接	白灯慢闪
	配对中	白灯快闪
	连接成功	白灯常亮
 电池容量	低电量	白灯快闪
	充电中	白灯慢闪
	充满电	白灯常亮

注: 麦克风每个功能图标的运行状态均与下方指示灯状态一一对应。

⑧ 紧固旋钮

可通过调整该旋钮的松紧度来调节麦克风的角度的。

⑨ 开关机/配对/RGB灯效切换键

长按切换键3秒开启或关闭发射器;

短按切换键三次, 可将发射器与接收器重新配对(发射器和接收器出厂前已配对成功, 因此产品开机后会自动配对。配对成功后, 发射器和接收器的指示灯均呈白灯常亮)

循环切换	动态流动
	呼吸渐变
	红灯
	洋红灯
	橙灯
	浅绿灯
	绿灯
	浅蓝灯
	深蓝灯
	紫灯
	白灯
	关灯

注: 当麦克风处于静音状态时,短按切换键无法进行灯效切换。

⑩ 3.5mm监听耳机口

插入耳机可实时监听麦克风。

⑪ USB-C充电/音频输出接口

接入标配的USB-C转USB-C或USB-C转USB-A数据线后,除了可以为发射器充电外,还支持将音频输出至带USB-C接口的手机、或带USB-C / USB-A接口的电脑等设备。
注意:当发射器与接收器连接成功后,请勿通过USB-C转USB-C或USB-C转USB-A数据线为发射器充电,以避免产生异常电流噪声。

⑫ 接收器(RX)

将接收器的 USB-A 或 USB-C 接头插入具备相应接口的设备。接收器状态指示灯状态如下:

- 未连接发射器时: 白灯慢闪;
- 配对过程中: 白灯快闪;
- 成功连接发射器后: 白灯常亮。

防喷网安装

将防喷网底部对准防震架前方两个插口插入,即可固定。

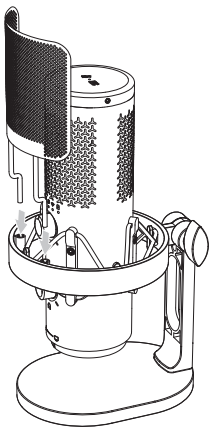

悬臂安装

1) 逆时针旋转紧固旋钮将麦克风从桌面支架上取出；

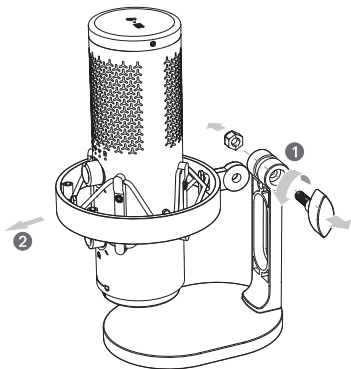

2) 通过5/8" 转3/8" 螺纹接头, 如下图所示将麦克风安装至悬臂支架上。

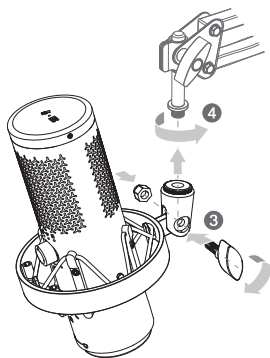

操作指南

启用麦克风

有线模式：

使用配套的一分二USB-C转USB-C/USB-A数据线连接麦克风至手机、电脑等。
连接电脑使用需设置程序，详情请参考“程序设置(有线)”。

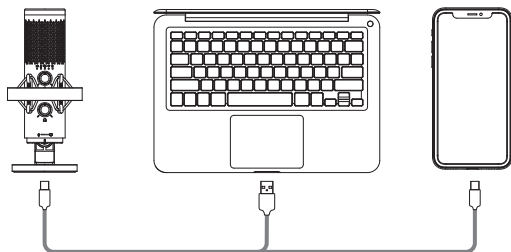

无线模式：

使用配套的接收器连接手机、电脑等。
连接电脑使用需设置程序，详情请参考“程序设置(无线)”。

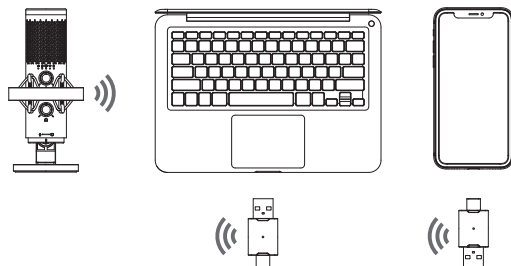

拾音规范

K5麦克风采用心形拾音模式,咪头位于麦克风正面,此模式下对正前方的声音拾取效果最佳。建议将麦克风正对声源,并保持5-15cm的距离,以获得最佳的拾音效果。

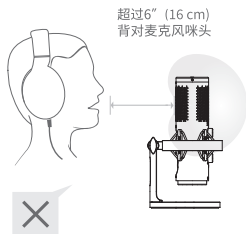
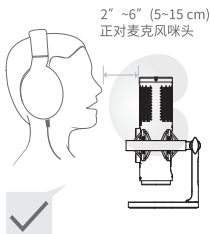

静音

轻触一下麦克风顶部开启或关闭静音。静音开启后,RGB灯呈红灯快闪。

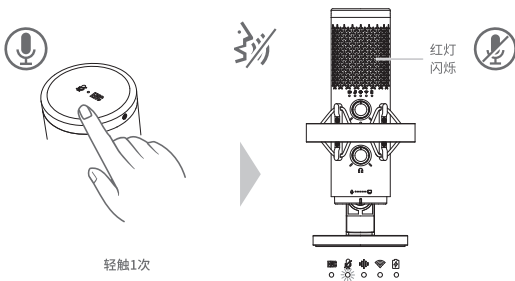

切换灯效

短按灯效切换键,循环切换灯效。

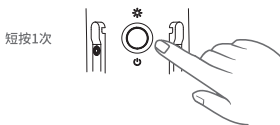

调整增益和耳机音量

- 增益：向右旋转增益旋钮增大增益；向左旋转减小增益。

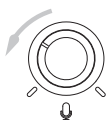

左转减少增益



转右放大增益

- 耳机音量：向右旋转增大耳机音量；向左旋转减小耳机音量。

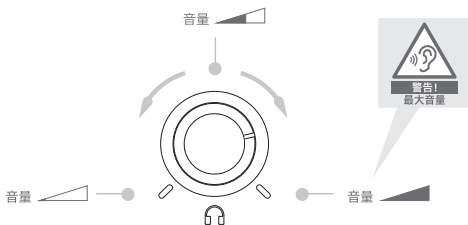

增益 / 音量调节

向右旋转：增加电脑监听音量减少麦克风增益。

向左旋转：增加麦克风增益减少电脑监听音量。

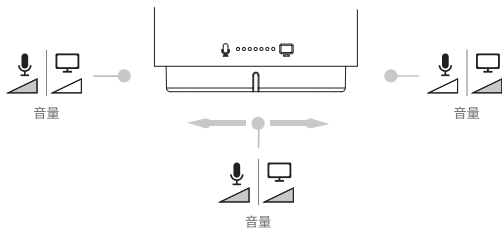

降噪

长按顶部2秒可开启或关闭降噪。开启降噪时, 功能指示灯亮起白色常亮灯; 关闭降噪时, 白色指示灯熄灭。

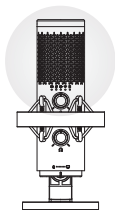

长按2秒开启或关闭ENC



重新配对

将接收器插入带有 USB-C 或 USB-A 接口的设备, 短按开关机/配对/RGB 灯效切换键 3 次。接收器状态指示灯白灯快闪, 表示正在重新与发射器配对。当接收器状态指示灯变为白灯常亮时, 表示接收器与发射器已成功重新配对。

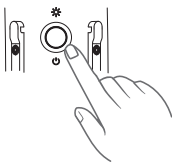

连续短按3次

开关机

长按此按键 3 秒可开启或关闭发射器。

注意:

- 开机/关机功能仅在无线模式下生效; 在有线模式下, 发射器会自动开机。
- 在无线模式下, 如果接收器未与发射器成功连接, 发射器将在 5 分钟内自动关机。



长按1次

程序设置(有线)

Mac系统程序设置

1. 使用随附的USB-A转USB-C数据线将K5接入电脑；
2. 打开“系统偏好设置”，然后选择“声音”图标；
3. 选择“ K5 TX ”为输入设备；
4. 选择“ K5 TX ”为输出设备。

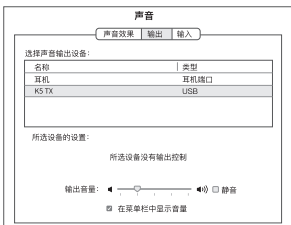
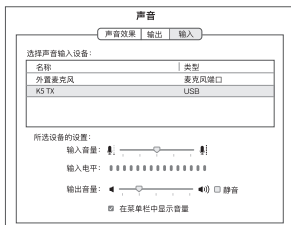

Windows系统程序设置

1. 使用随附的USB-A转USB-C数据线将K5接入电脑；
2. 打开“设置”，进入“系统”→“声音”→“声音控制面板”；
3. 在“播放”选项卡下选择“ K5 TX ”为默认设备；
4. 在“录制”选项卡下选择“ K5 TX ”为默认设备。

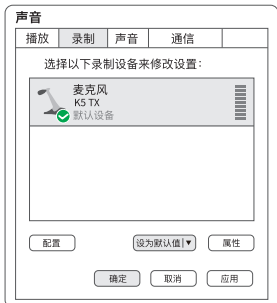

程序设置(无线)

Mac系统程序设置

1. 使用配套的无线接收器连接电脑；
2. 打开“系统偏好设置”，然后选择“声音”图标；
3. 选择“K5 RX”为输入设备；
4. 选择“K5 RX”为输出设备。

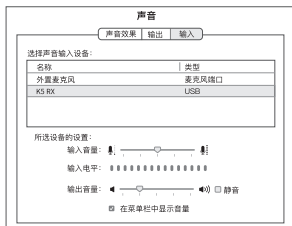

Windows系统程序设置

1. 使用配套的无线接收器连接电脑；
2. 打开“设置”，进入“系统”→“声音”→“声音控制面板”；
3. 在“播放”选项卡下选择“K5 RX”为默认设备；
4. 在“录制”选项卡下选择“K5 RX”为默认设备。



参数

声学原理	电容麦
拾音模式	心型
频率响应	20 Hz~20 kHz
灵敏度 (最大增益)	-10 dBfs at 80 dB spl
灵敏度 (最小增益)	-46 dBfs at 80 dB spl
采样率	48 kHz
比特率	24 bit
信噪比	75 dB
最大声压级	108 dB SPL
最小输出阻抗	16 Ω
接口类型	3.5 mm耳机监听孔
	USB-C输出接口 (USB 2.0 高速)
电池容量	3.7 V 800 mAh
麦克风续航	开RGB灯: 20小时; 关RGB灯: 50小时
充电时间	3小时
无线传输距离	10米
尺寸 (带支架)	124 mm长 x 100 mm宽 x 221 mm高
重量 (带支架)	474 g
电源要求	最高支持5 V, 1 A
兼容系统	Windows: 10.0 或以上, macOS: 10.15或以上, Android: 9.0 或以上, iPadOS*: 14或以上 (需要支持USB-C的苹果设备)
工作温度	0 °C 至 +40 °C (32 °F 至 104 °F)
贮存温度	-20 °C 至 +70 °C (-4 °F 至 158 °F); 10 至 95 %, 不冷凝

极性模式

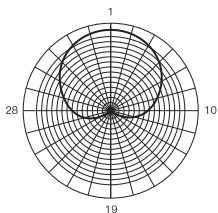

频率响应

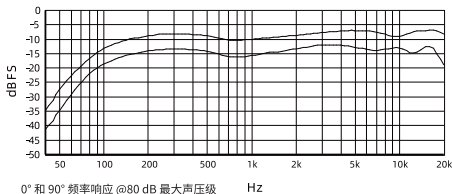

包装清单

K5麦克风(含防震支架和桌面支架) × 1

防喷网 × 1

一分二USB-C转USB-C / USB-A数据线(1.8m) × 1

5/8"转3/8"螺纹接头 × 1

无线接收器 × 1

支架转换头 × 1

SHENZHEN JIAYZ PHOTO INDUSTRIAL., LTD.

The BOYA logo is a trademark which is registered and owned by Shenzhen Jiayz Photo Industrial., Ltd.

深圳市长丰影像器材有限公司

地址:广东省深圳市龙华区观澜街道大富社区硅谷动力智能终端产业园A16栋

TEL: 400 613 1096

Email: support@boya-mic.com

www.boyamic.com / www.jiayz.com